

4" SW SAND WARRIOR BOREHOLE PUMPS SERIES - 50Hz



Sand Warrior Pump

Maximum Sand Resistance up to 450 g/m³

Wide Operating Voltage

(160V to 240V for single phase 50Hz)

(350V to 415V for three phase 50Hz)

Specially engineered and manufactured for Sandy Wells and Wide Operating Voltage.

The Floating Impeller and Materials Selection ensured an excellent resistance against sand.

PUMPS SPECIFICATIONS:

- Delivery up to 24 m³/h
- Head up to 527 m
- Motor size up to 7.5 kW/ 10 Hp
- Outlet size of 1.25", 1.5" and 2"
- Max. pump diameter of 97 mm
- NEMA standard dimensions

MOTORS SPECIFICATIONS:

- Oil filled rewindable motor
- IP 68 protection
- Class B insulation
- High quality Mechanical Seal
- High quality Bearings
- Max. water temp. of 35° Celsius

4" SW SAND WARRIOR BOREHOLE PUMPS SERIES - 50Hz

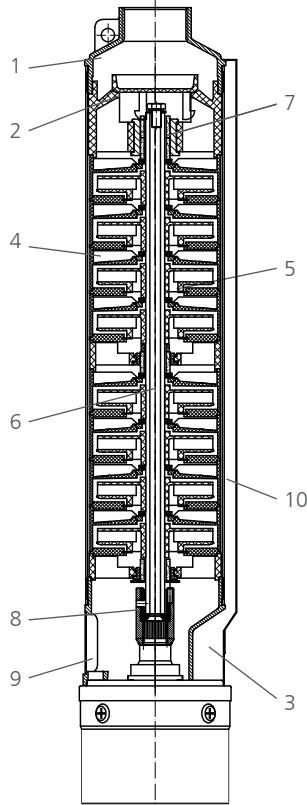

Ref. No.	Description	Material
1	Discharge Head	Stainless Steel 201 / 304 / Brass
2	Non Return Valve	Polycarbonate
3	Motor Adaptor	Stainless Steel 201 / 304 / Brass
4	Impeller	Polyoxymethylene*
5	Diffuser	Polycarbonate with Ceramic Insert
6	Shaft	Stainless Steel 431
7	Bearing	N.B.R
8	Coupling	Stainless Steel 304
9	Filter	Stainless Steel 201 / 304
10	Cable Guard	Stainless Steel 201 / 304

*Polyoxymethylene material is an engineered composites specially known for its strong abrasion resistance against sand.

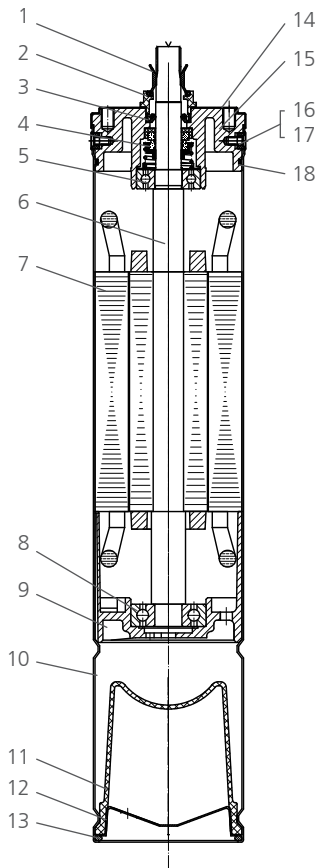

Ref. No.	Description	Material
1	Sand Proof Cup	N.B.R
2	Sand Proof Seat	Plastic
3	Oil Seal	N.B.R
4	Mechanical Seal	Graphite - Ceramic
5	Bearing	C&U
6	Rotor	45#+303
7	Stator	Copper Wire + Cold Silicon Sheet
8	Bearing	C&U
9	Bearing Seat	Aluminium
10	Sleeve	Stainless Steel 201 / 304
11	Rubber Cup	N.B.R
12	End Cover	Stainless Steel 201 / 304
13	Clamping Spring	Stainless Steel 201 / 304
14	Oil Chamber Cover	Stainless Steel 304
15	Oil Chamber	Cast Iron/Brass
16	Locking Ring	Stainless Steel 304
17	Screw	Stainless Steel 304
18	O-Ring	N.B.R

4" SW 2 - 50 Hz - 2850 RPM

4" SW 3 - 50 Hz - 2850 RPM

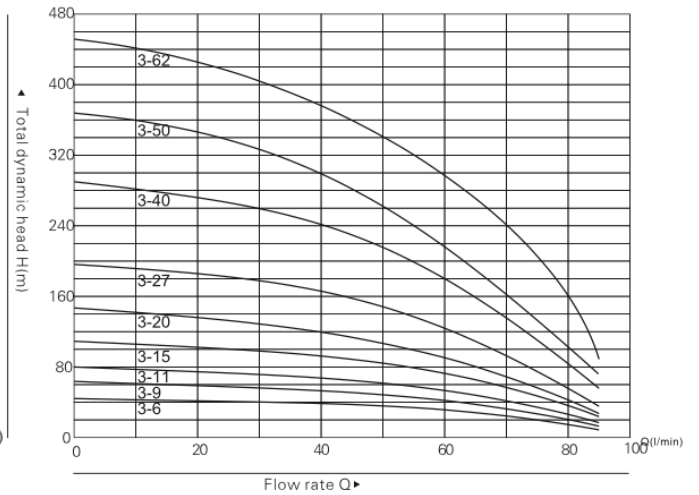
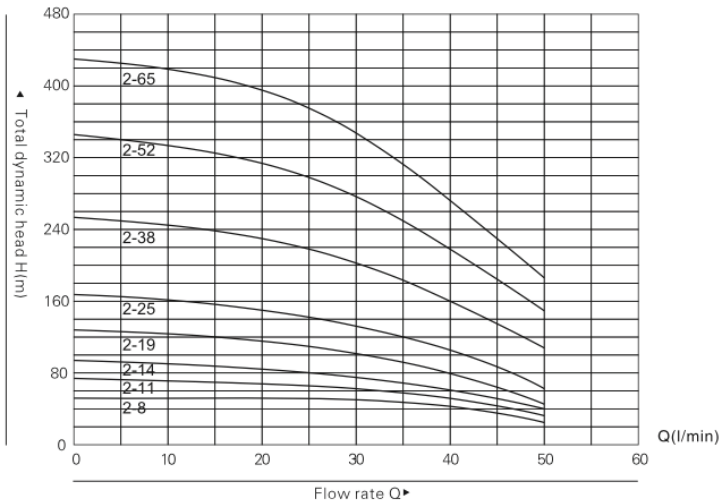

Type	N. of Stages	Motor		Pump Outlet (inch)	Q	Delivery									
		KW	HP			m3/h	0	0.9	1.2	1.5	1.8	2.1	2.4	2.7	3.0
SW 2-8	8	0.37	0.50	1.25"	l/min	0	0	15	20	25	30	35	40	45	50
SW 2-11	11	0.55	0.75	1.25"	Head H m	53	51	48	46	42	38	34	28	23	
SW 2-14	14	0.75	1.00	1.25"		75	70	67	63	58	52	46	39	31	
SW 2-19	19	1.10	1.50	1.25"		93	89	85	80	74	67	59	50	40	
SW 2-25	25	1.50	2.00	1.25"		126	120	115	109	100	90	80	67	54	
SW 2-38	38	2.20	3.00	1.25"		166	158	151	143	132	119	105	89	71	
SW 2-52	52	3.00	4.00	1.25"		252	240	230	218	201	181	160	135	108	
						345	329	315	298	275	248	218	184	148	

Type	N. of Stages	Motor		Pump Outlet (inch)	Q	Delivery									
		KW	HP			m3/h	0	1.2	1.8	2.4	3.0	3.6	4.2	4.8	5.4
SW 3-6	6	0.37	0.50	1.25"	l/min	0	0	20	30	40	50	60	70	80	90
SW 3-9	9	0.55	0.75	1.25"	Head H m	44	41	39	36	32	27	21	15	9	
SW 3-11	11	0.75	1.00	1.25"		65	62	59	54	48	41	32	23	13	
SW 3-15	15	1.10	1.50	1.25"		80	76	72	66	59	50	39	28	16	
SW 3-20	20	1.50	2.00	1.25"		109	104	98	90	81	68	53	39	22	
SW 3-27	27	2.20	3.00	1.25"		145	138	130	120	108	90	70	52	29	
SW 3-40	40	3.00	4.00	1.25"		196	186	176	162	145	122	95	70	39	
SW 3-50	50	4.00	5.50	1.25"		290	276	260	240	215	180	140	103	58	
						363	345	325	300	269	225	195	129	72	

4" SW 4 - 50 Hz - 2850 RPM

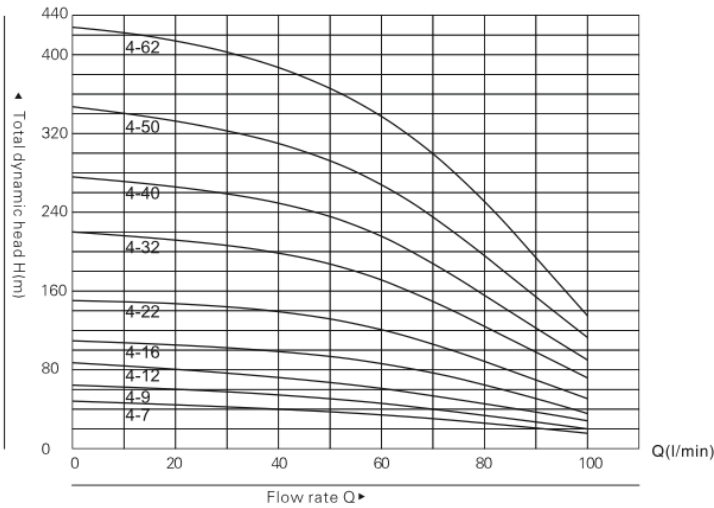

4" SW 6 - 50 Hz - 2850 RPM

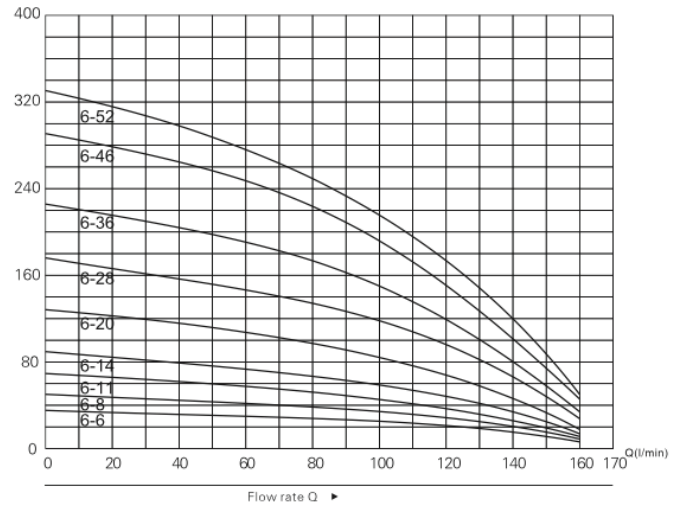

Type	N. of Stages	Motor		Pump Outlet (inch)	Q	Delivery									
		KW	HP			m ³ /h	0	1.8	2.4	3.0	3.6	4.2	4.8	5.4	6.0
					l/min	0	30	40	50	60	70	80	90	100	
SW 4-7	7	0.55	0.75	1.25"	Head H m	48	45	43	41	38	33	27	22	16	
SW 4-9	9	0.75	1.00	1.25"		62	58	55	53	49	43	35	28	20	
SW 4-12	12	1.10	1.50	1.25"		83	78	73	71	65	57	46	37	27	
SW 4-16	16	1.50	2.00	1.25"		110	104	98	94	86	76	62	49	36	
SW 4-22	22	2.20	3.00	1.25"		151	143	134	130	119	104	85	68	49	
SW 4-32	32	3.00	4.00	1.25"		220	208	195	189	173	151	124	99	71	
SW 4-40	40	4.00	5.50	1.25"		275	260	244	236	216	189	154	124	89	

Type	N. of Stages	Motor		Pump Outlet (inch)	Q	Delivery									
		KW	HP			m ³ /h	0	1.2	2.4	3.6	4.8	6.0	7.2	8.4	9.6
					l/min	0	20	40	60	80	100	120	140	160	
SW 6-6	6	0.55	0.75	2"	Head H m	38	36	34	32	29	25	20	13	6	
SW 6-8	8	0.75	1.00	2"		50	48	45	43	39	34	26	17	8	
SW 6-11	11	1.10	1.50	2"		69	66	62	59	54	46	36	23	10	
SW 6-14	14	1.50	2.00	2"		88	85	78	75	68	59	46	30	13	
SW 6-20	20	2.20	3.00	2"		126	121	112	107	98	84	65	43	19	
SW 6-28	28	3.00	4.00	2"		177	169	157	150	137	118	92	60	26	
SW 6-36	36	4.00	5.50	2"		227	218	202	192	176	152	118	77	34	
SW 6-46	46	5.50	7.50	2"		290	278	258	246	225	194	151	98	43	

4" SW 8 - 50 Hz - 2850 RPM

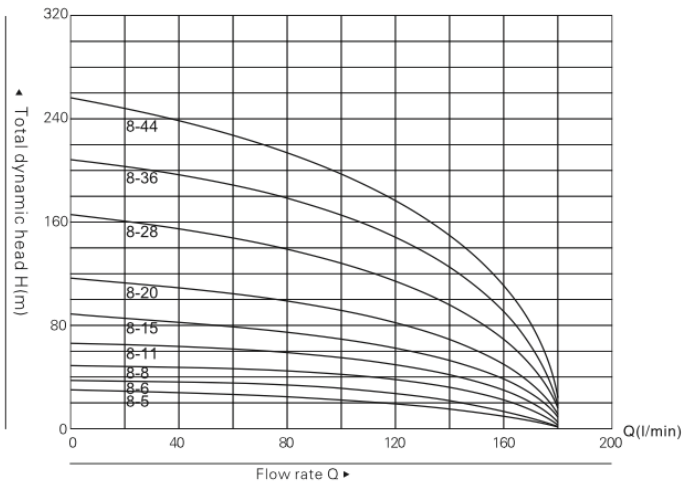

4" SW 10 - 50 Hz - 2850 RPM

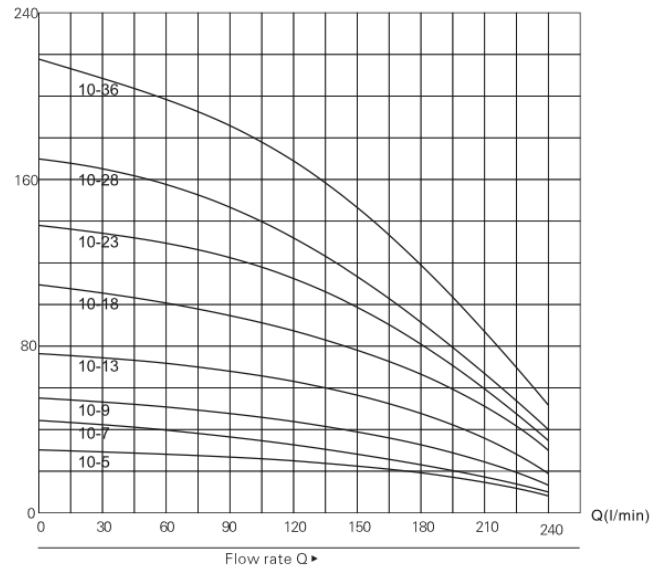

Type	N. of Stages	Motor		Pump Outlet (inch)	Q	Delivery									
		KW	HP			m3/h	0	2.4	3.6	4.8	6.0	7.2	8.4	9.6	10.8
					l/min	0	40	60	80	100	120	140	160	180	
SW 8-5	5	0.55	0.75	2"	Head H m	29	27	26	25	23	20	17	13	3	
SW 8-6	6	0.75	1.00	2"		35	33	31	29	27	24	21	15	3	
SW 8-8	8	1.10	1.50	2"		46	44	41	39	36	32	27	21	4	
SW 8-11	11	1.50	2.00	2"		64	60	57	54	50	45	38	28	6	
SW 8-15	15	2.20	3.00	2"		87	82	78	74	68	61	51	39	8	
SW 8-20	20	3.00	4.00	2"		116	109	103	98	91	81	69	52	10	
SW 8-28	28	4.00	5.50	2"		162	153	145	137	127	114	96	72	14	
SW 8-36	36	5.50	7.50	2"		209	196	186	177	163	146	123	93	18	

Type	N. of Stages	Motor		Pump Outlet (inch)	Q	Delivery								
		KW	HP			m3/h	0	1.8	3.6	5.4	7.2	9.0	10.8	12.6
					l/min	0	30	60	90	120	150	180	210	240
SW 10-5	5	0.75	1.00	2"	Head H m	30	30	28	26	24	21	16	13	7
SW 10-7	7	1.10	1.50	2"		42	41	39	37	34	29	22	17	10
SW 10-9	9	1.50	2.00	2"		55	53	50	47	43	37	28	22	13
SW 10-13	13	2.20	3.00	2"		79	77	72	68	63	54	41	37	19
SW 10-18	18	3.00	4.00	2"		109	107	100	94	87	75	57	51	26
SW 10-23	23	4.00	5.50	2"		139	136	127	121	111	95	72	59	33
SW 10-28	28	5.50	7.50	2"		170	166	155	147	135	116	88	68	40
SW 10-36	36	7.50	10.00	2"		218	213	199	189	174	149	113	82	52

4" SW 12 - 50 Hz - 2850 RPM

4" SW 16 - 50 Hz - 2850 RPM

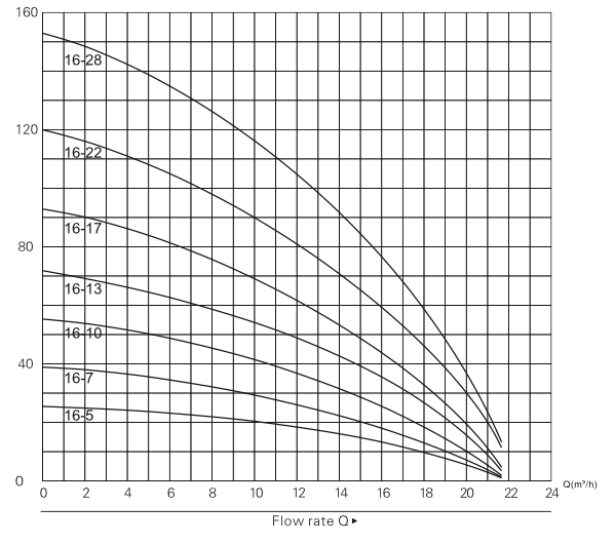
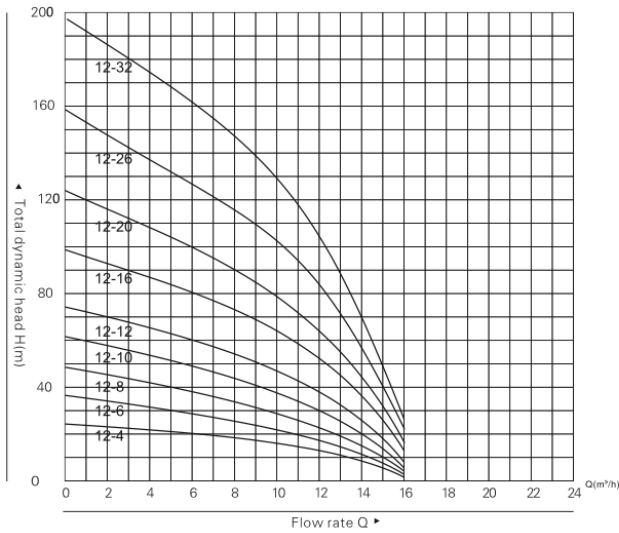

Type	N. of Stages	Motor		Pump Outlet (inch)	Q	Delivery									
		KW	HP			m3/h	0	2.0	4.0	6.0	8.0	10.0	12.0	14.0	16.0
SW 12-4	4	0.75	1.00	2"	l/min	0	33	67	100	133	167	200	233	267	
SW 12-6	6	1.10	1.50	2"	Head H m	24	23	21	19	16	14	10	6	2	
SW 12-8	8	1.50	2.00	2"		36	34	32	29	26	22	17	11	3	
SW 12-10	10	2.20	3.00	2"		49	46	43	40	36	30	24	16	5	
SW 12-12	12	2.20	3.00	2"		61	58	53	49	44	38	30	20	6	
SW 12-16	16	3.00	4.00	2"		73	70	65	58	53	45	36	24	8	
SW 12-20	20	4.00	5.50	2"		98	93	86	80	71	62	51	36	13	
SW 12-26	26	5.50	7.50	2"		123	116	108	100	89	78	64	45	16	
SW 12-32	32	7.50	10.00	2"		159	151	140	130	115	101	83	59	21	
					196	186	172	160	142	124	102	72	26		

Type	N. of Stages	Motor		Pump Outlet (inch)	Q	Delivery								
		KW	HP			m3/h	0	6.0	8.0	10.0	12.0	14.0	16.0	18.0
SW 16-5	5	1.10	1.50	2"	l/min	0	100	130	165	200	230	265	300	360
SW 16-7	7	1.50	2.00	2"	Head H m	27	24	22	20	19	17	14	11	3
SW 16-10	10	2.20	3.00	2"		38	34	31	27	26	24	20	16	4
SW 16-13	13	3.00	4.00	2"		55	48	45	39	37	34	28	23	6
SW 16-17	17	4.00	5.50	2"		71	63	58	51	48	44	36	29	7
SW 16-22	22	5.50	7.50	2"		93	82	76	66	62	58	48	38	9
						120	106	99	86	80	75	62	50	11
SW 16-28	28	7.50	10.00	2"		153	135	125	109	101	95	78	63	14